

# (SWW) SLIDING WING WALL



Sliding Wing Wall systems are essentially sliding wall systems but instead are mounted and stack on the outside of the opening in front of a wall. Wing wall systems come with two or more doors and can be configured in a symmetrical fashion (i.e. SWW6S, SWW4S). Our proprietary RGS™ hardware allows the doors to telescope across the opening without the use of a floor track. Flush bolts are used to anchor the system at set intervals when needed. Allow 3" for each overlapping stile.

## Standard opening widths

System	Opening Widths *
SWW2	58", 68", 78", 88"
SWW3	86", 101", 116", 131"
SWW4	114", 134", 154", 174"
SWW4S	117", 137", 157", 177"
SWW6S	173", 203", 233", 263"

\* Opening widths listed are from finished wall to finished wall.

## Standard heights

Track	Opening Height *
Standard	83", 95", 107", 119"
Low Profile	82-1/4", 94-1/4", 106-1/4", 118-1/4"

\* Opening heights are from finished floor to top of leveled track

## Panel models

225, 175, 175F

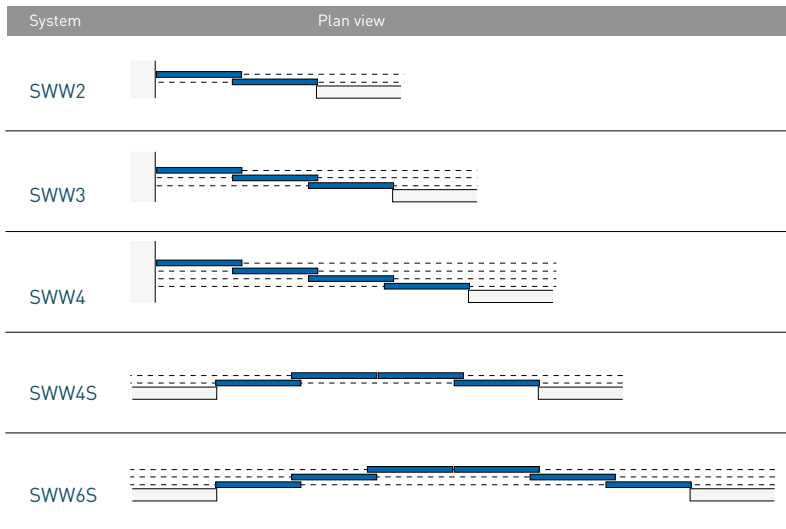

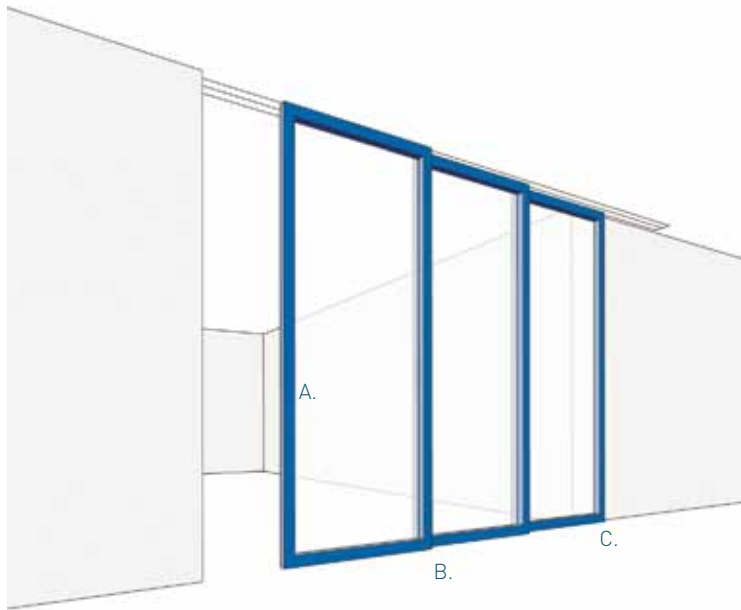

## Operation Overview

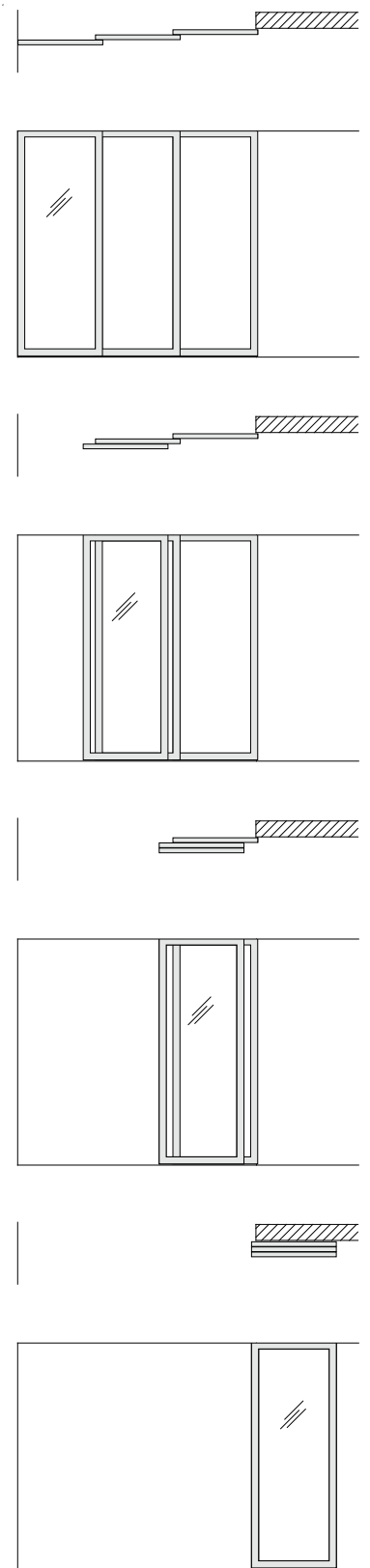

## Features

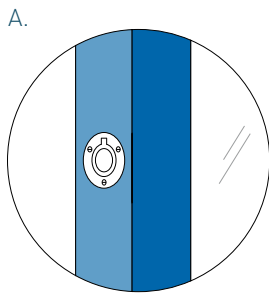

### Edge mounted ring pull

Indicates the lead door when stacked, and can be used to pull the doors across the opening.

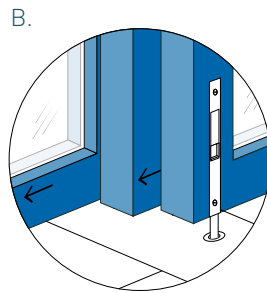

### Telescoping RGST™ & stabilizing flush bolts

The Raydoor Guiding System™ allows one door to extract all the panels in one motion with no floor tracks. Mortised flush bolts and discreet spring loaded floor strikes provide stability.

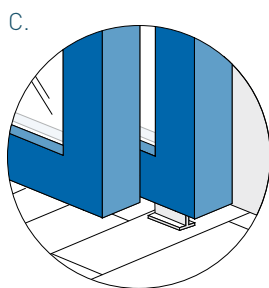

### Grey Floor Guide

Keeps the system aligned along the outside wall during operation.

